

**01** SECTION - BEAMS  
Scale: 1:10

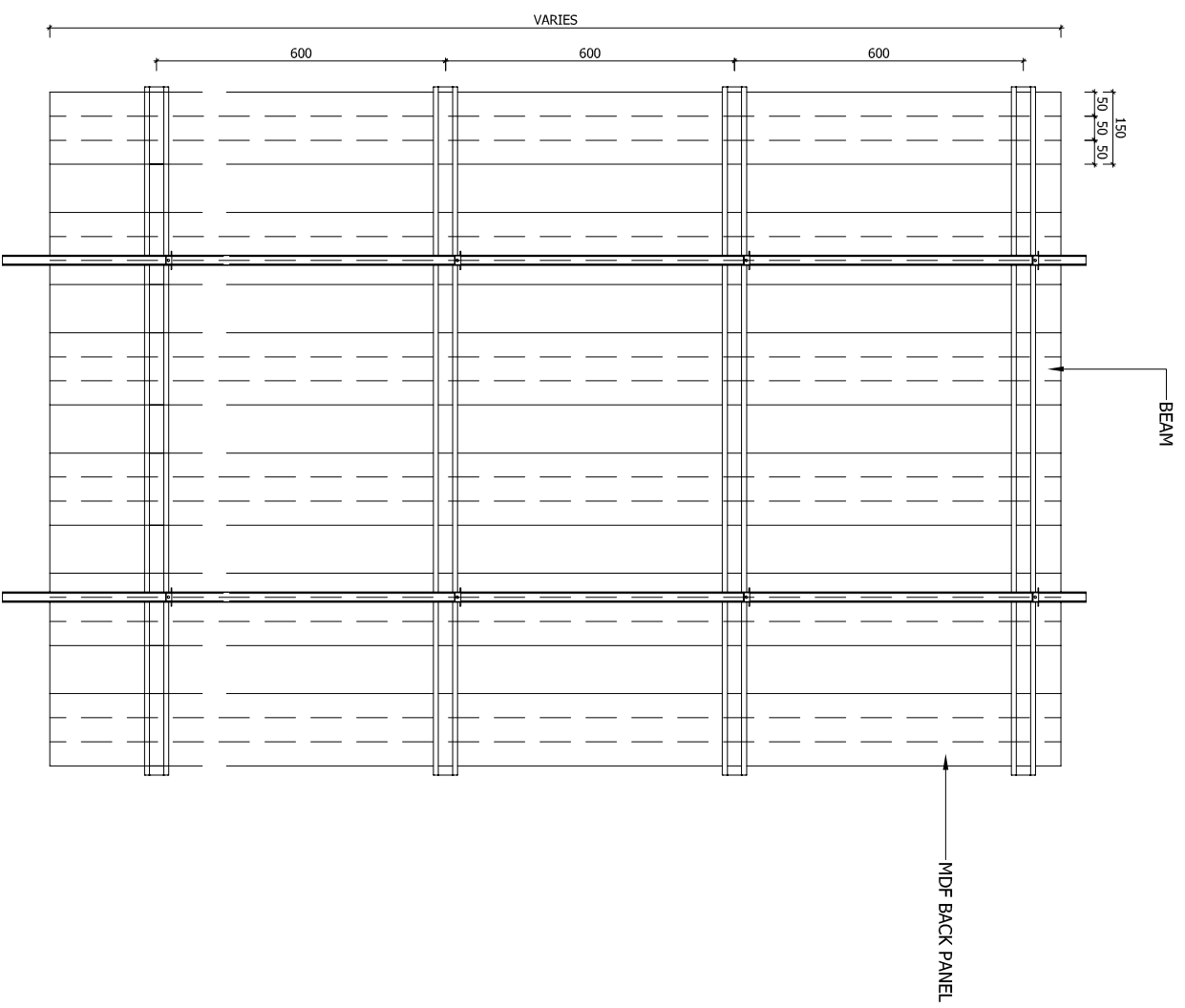

**02** RCP - BEAMS  
Scale: 1:15

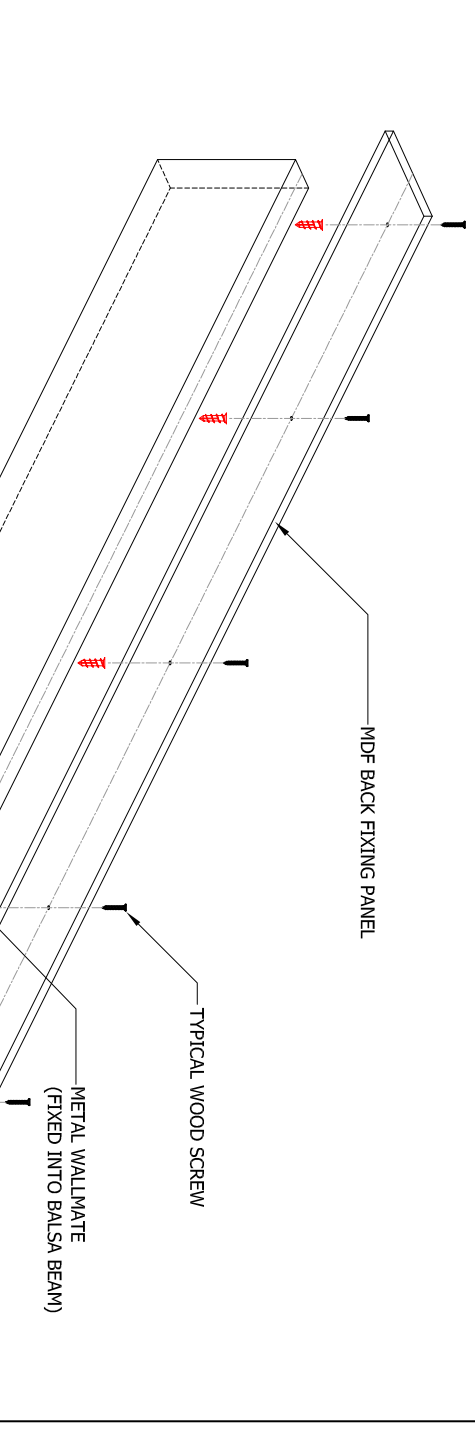

**04** ISOMETRIC - BEAM FIXING DETAIL  
Scale: NTS



**06** 3D - BEAMS  
Scale: NTS

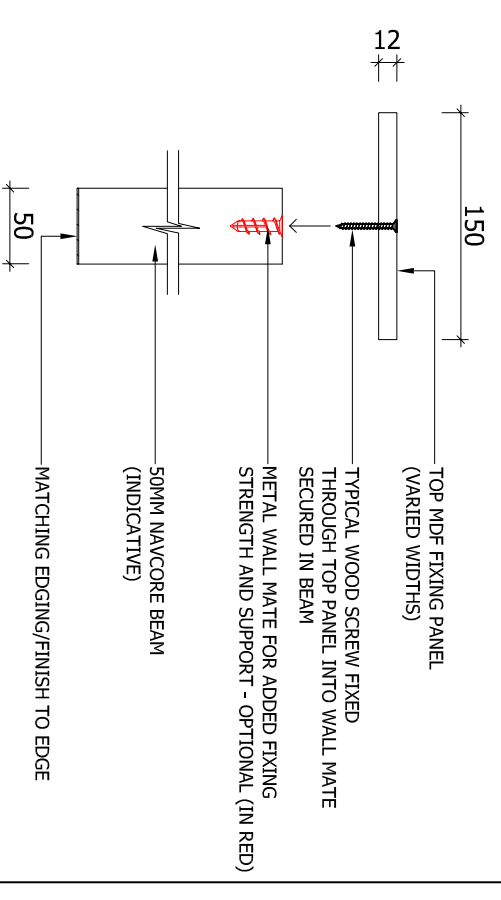

**03** SECTION - TYPICAL BEAM  
Scale: 1:2

TYPICAL SIZES	
LENGTH	WIDTH
2950	200
2390	200

\*SIZES AND THICKNESSES ARE SHOWN AS TYPICAL ONLY - CUSTOM SIZES AND THICKNESSES CAN BE ACCOMMODATED FOR ON REQUEST